

Y:\PROJECTS\218193 CA PARKS ANTON DAM REMOVAL\218193 CAD\218193 SHEETS\218193-30-PLAN.DWG

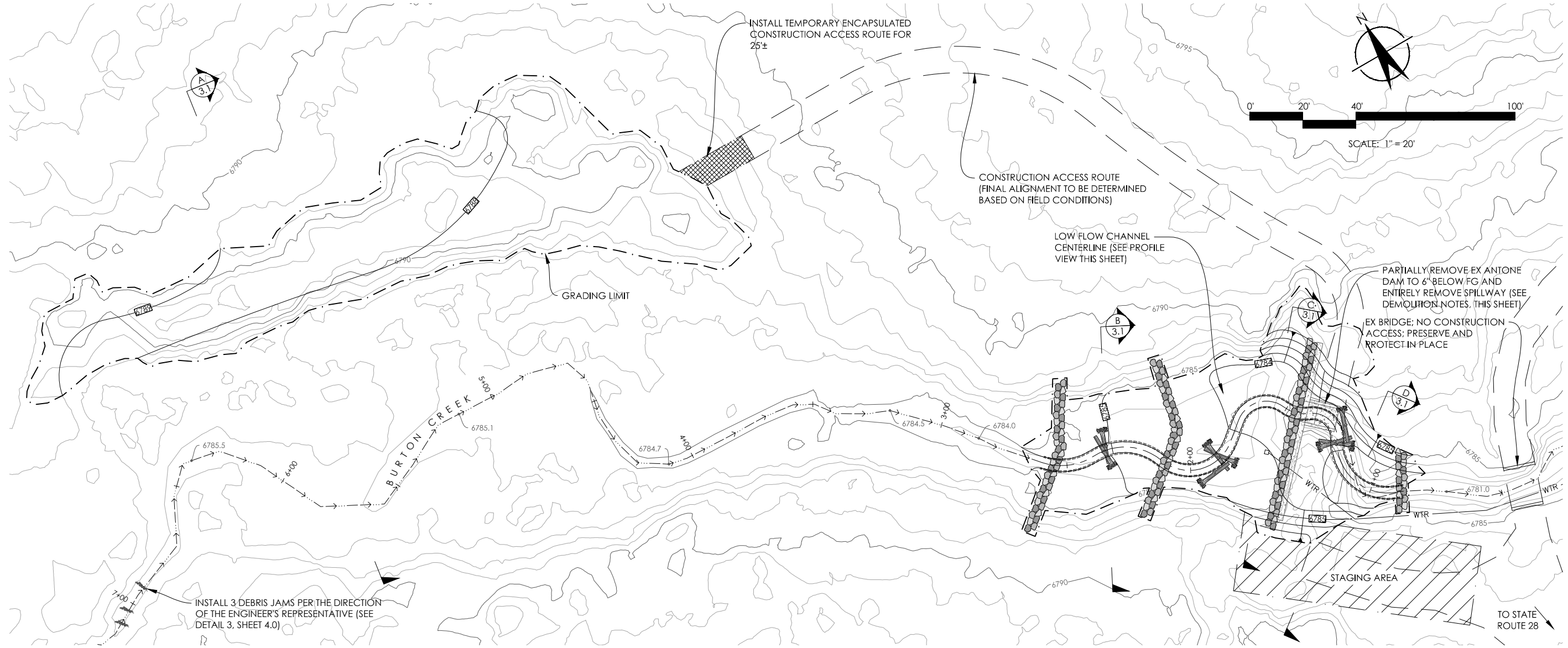

**DEMOLITION NOTES:**

1. THE CONTRACTOR SHALL DEMOLISH THE DAM AND SPILLWAY TO WITHIN 6" OF FINISHED GRADE. DEMOLITION SHALL INCLUDE BREAKDOWN AND REMOVAL OF ALL CONCRETE, REBAR, WOOD, CINDER BLOCKS AND OTHER MATERIALS COMPRISING THE DAM AND SPILLWAY.
2. ALL EXCESS MATERIALS FROM CLEARING AND GRUBBING, DAM DEMOLITION, AND EARTHWORK OPERATION SHALL BE OFF-HAULED FROM THE PROJECT SITE AND DISPOSED OF CONSISTENT WITH ALL FEDERAL, STATE, AND LOCAL REGULATIONS.

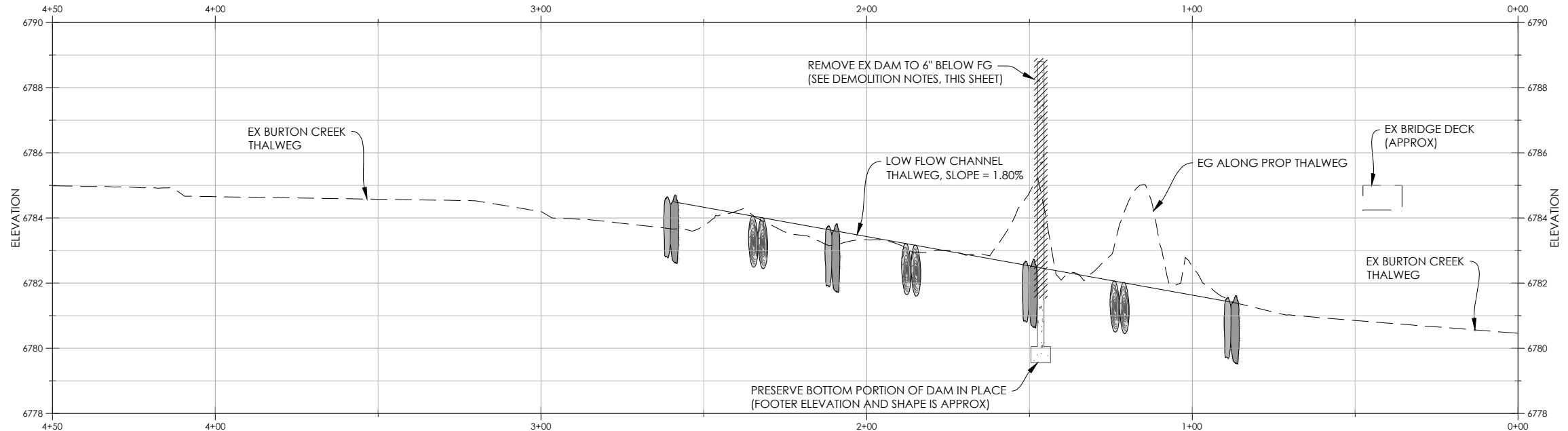

50% PLANS - NOT FOR CONSTRUCTION

| DESIGNED BY | DATE     | BY | DATE | BY | DATE |
|-------------|----------|----|------|----|------|
| PK/DS       | 1-2-19   | PK |      |    |      |
| DRAWN BY    |          | PK |      |    |      |
| CHECKED BY  |          | DS |      |    |      |
| IN CHARGE   |          |    |      |    |      |
| DATE        | 1-2-2019 |    |      |    |      |

**CHANNEL RESTORATION  
 PLAN AND PROFILE**  
 ANTON DAM REMOVAL AND MEADOW  
 RESTORATION AT BURTON CREEK STATE PARK  
 PLACER COUNTY, CALIFORNIA  
 CALIFORNIA STATE PARKS

|                |          |
|----------------|----------|
| PROJECT NUMBER | 218193   |
| SCALE          | 1" = 20' |
| SHEET          |          |

3.0