



## MOTORHOME, R.V. & TRAILER OWNERS:

\*Read this notice BEFORE you park your vehicle.\*

\*Regulations are enforced YEAR-ROUND\*

All vehicles must be properly parked at all times in accordance with governing regulations and bear in mind that Department personnel may specify the arrangement of your recreational equipment at any time (Title 14, California Code of Regulations, Sec. 4323).

### Follow these rules to avoid citations:

1. Park vehicle in marked spaces between white lines. No parking across spaces, no straddling lines, etc. CVC 21113(a)
2. Oversized and towed vehicles that cannot fit into one space must park in the middle row so they occupy only two spaces (one in front of the other). CVC 21113(a), CCR 4358
3. No slide-out rooms, no awnings, no chairs, no tables, no e-z ups, no BBQs, no astro-turf, no bikes can occupy adjacent spaces. Only vehicles are allowed in parking spaces. Additional spaces may not be purchased for above purposes. CVC 21954(a), CVC 22505(b), CCR 4323, CCR 4358
4. No animals can be outside of the vehicle without a leash being controlled by a person. No tethering animal to vehicle or making an animal pen. HSC 122335(b), CCR 4312(b)
5. Areas within the parking lot, not designated for vehicles, are not to be occupied by any object or person at any time. These areas are painted in yellow or red at Bolsa Chica State Beach. They are marked “Keep Clear” at Huntington State Beach. CVC 21113(a), CVC 22505(b), CVC 21954(a), CCR 4323, CCR 4358

**Due to vehicle traffic, the parking lot is a very unsafe area. Do not allow your children to play in the parking lots. For their safety, please have them play on the sand.**

**Remember the parking lot is just that, it is not a picnic or camping area.**

**Maximum oversize vehicle length is 40 feet.**

Three examples of **illegal** parking:

Examples of **legal** parking:

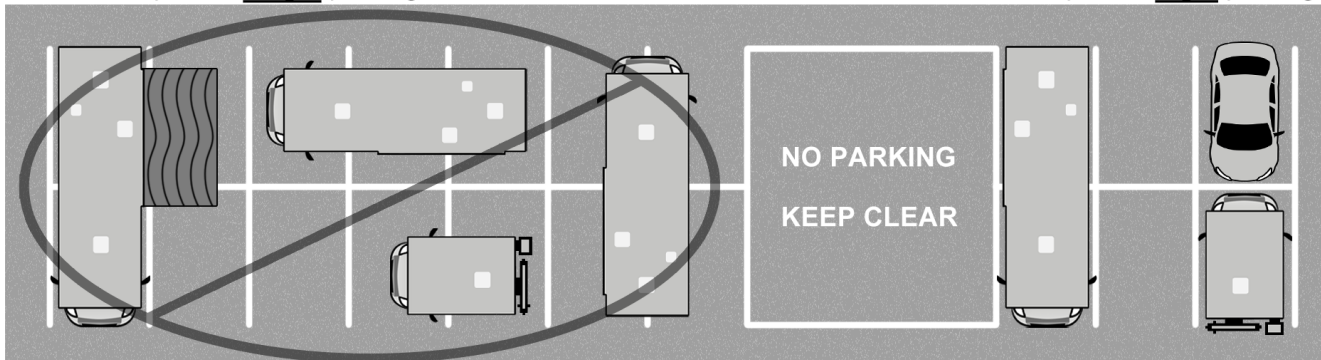

1. No awnings 2. No parking across lines 3. No straddling.

More than 25' Less than 25'