

4 THE CONNECTIVE DECK

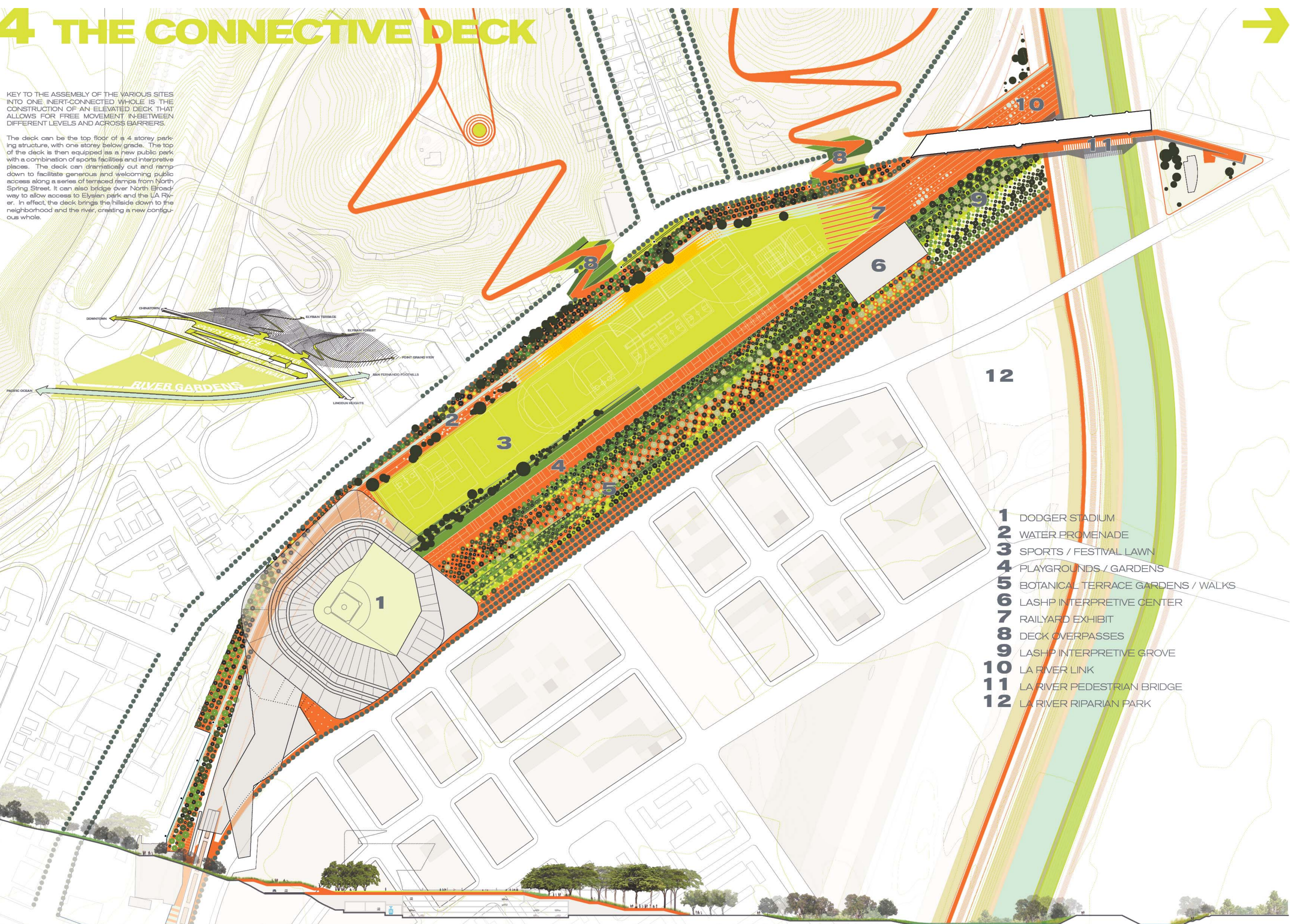

KEY TO THE ASSEMBLY OF THE VARIOUS SITES INTO ONE INERT-CONNECTED WHOLE IS THE CONSTRUCTION OF AN ELEVATED DECK THAT ALLOWS FOR FREE MOVEMENT IN-BETWEEN DIFFERENT LEVELS AND ACROSS BARRIERS.

The deck can be the top floor of a 4 storey parking structure, with one storey below grade. The top of the deck is then equipped as a new public park with a combination of sports facilities and interpretive places. The deck can dramatically cut and ramp down to facilitate generous and welcoming public access along a series of terraced ramps from North Spring Street. It can also bridge over North Broad way to allow access to Elysian park and the LA River. In effect, the deck brings the hillside down to the neighborhood and the river, creating a new contiguous whole.

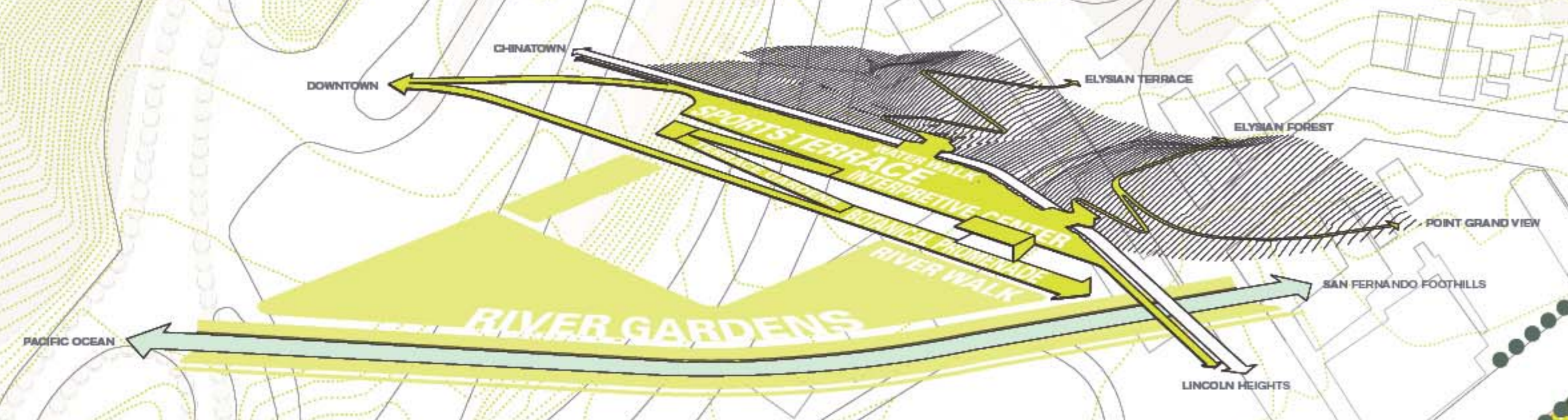

- 1** DODGER STADIUM
- 2** WATER PROMENADE
- 3** SPORTS / FESTIVAL LAWN
- 4** PLAYGROUNDS / GARDENS
- 5** BOTANICAL TERRACE GARDENS / WALKS
- 6** LASHP INTERPRETIVE CENTER
- 7** RAILYARD EXHIBIT
- 8** DECK OVERPASSES
- 9** LASHP INTERPRETIVE GROVE
- 10** LA RIVER LINK
- 11** LA RIVER PEDESTRIAN BRIDGE
- 12** LA RIVER RIPARIAN PARK

NORTH BROADWAY

NORTH SPRING

